

Data Sheet

Coaxial Relay CX-140D



MECHANICAL CHARACTERISTICS :

Contact Arrangement	SPDT
RF Contacts	Break before make
Operational Temperature	- 25°C to + 50°C
Max Temperature Rise	20°C
Weight	Approx. 95 g
Mounting	Four screws
Cable Connections	N-Female, directly connect cables

ELECTRICAL CHARACTERISTICS :

Impedance	50 Ohms
Nominal Voltage	12 V DC
Voltage Range	10 V DC - 14 V DC
Current	80 mA @12 V DC 20°C
Coil Resistance	150 ±10% Ohms @ 20°C

RF-PROPERTIES :

Frequency MHz	VSWR max	Isolation -dB(min)	Ins. Loss -dB(max)	RF Power input W
50	1.03	55	0.08	250
150	1.03	51	0.10	250
500	1.05	47	0.15	200
1000	1,06	34	0.20	150
1500	1.20	28	0.25	100

ACTUATION DATA :

Pull In	10 V DC - 14 V DC (12 V DC nominal)
Drop Out	3 V DC min.

SWITCHING TIME :

Pull In	15 ms typical
Drop Out	10 ms typical
Life Expectancy	500.000 Operations min.

Coaxial Relay CX-140D

DIMENSIONS :

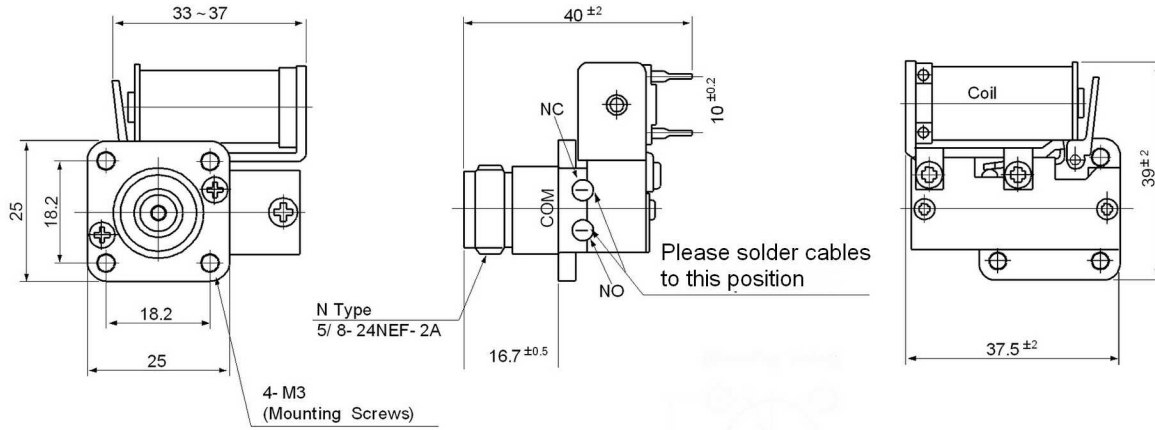

Typical Operating Curves :

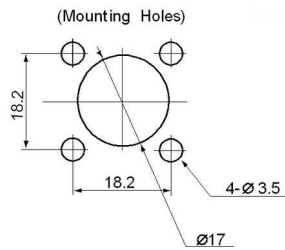
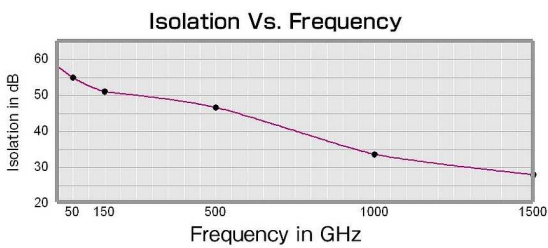
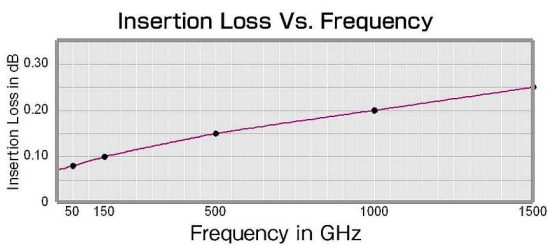
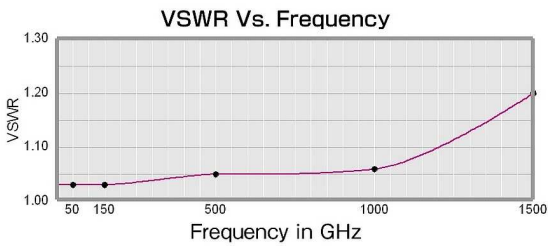

Cable Termination

Outer Conductor

Coating

Inner Conductor

2.5D2V

Outer Conductor (Shield Part)

(Soldering Slightly)

5 3.5

Schematic:

